

# KOSMOS

## Air Box M&K

Studio Kosmos Architects  
Chicago, New York Center  
Lead Architect  
Date: 2012  
Area: 4,800 sq. ft.  
Photography: Tom Rasmussen  
Date: February 13, 2013

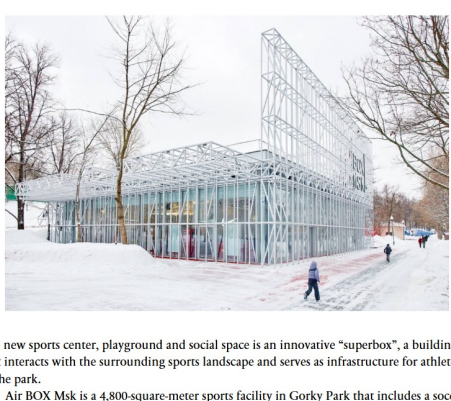

The new sports center, playground and social space is an innovative "superbox", a building that interacts with the surrounding sports landscape and serves as infrastructure for athletes in the park.

Air Box M&K is a 4,800-square-meter sports facility in Gorky Park that includes a soccer field, a basketball court, and a multifunctional gymnasium for fitness, yoga, and athletic activities. It is also home to the Nike running club. The entire site is an open public space, and access to the building, as well as to the training sessions and courses, is free for everyone.

The main architectural intention of the project was to create a transparent structure underlying the accessibility of the space. The facade with its 3-dimensional metal lattice functions as a membrane between interior space and the park, letting inside the air, the light and the people flows.

Air Box M&K is a "skin" structure, see-through and transparent, revealing all the processes inside even the MEP room with all its installations and cores is completely visible from the street.

Bright magenta floor works on the contrast with the greenery of the park and provides energy for sports achievements.

Simple square plan of the building is divided into 4 conceptual parts: entrance hall, multi-purpose hall, dressing rooms / closet zone, utility block. Translucent partition enables to unite the entrance hall and the multi-purpose hall for specific events, while transparent walls of the facade visually unite the interior with the surrounding park.

Open framework of the building allows it to integrate in the greenery of the park and lets the existing trees to grow through it.

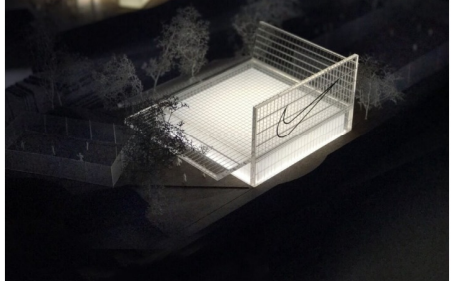
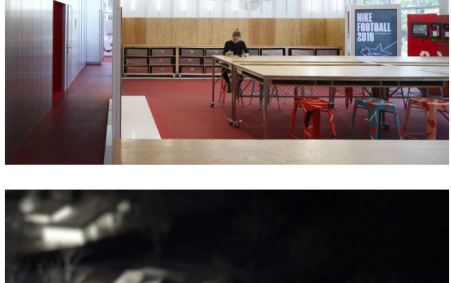
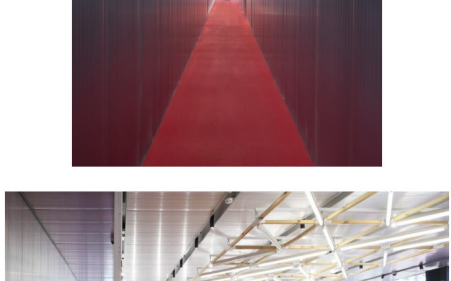
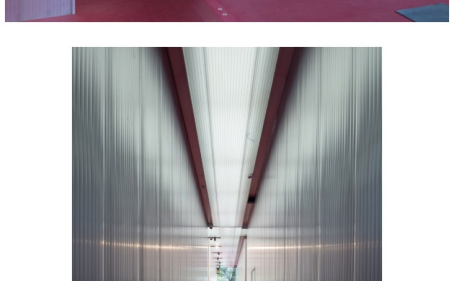
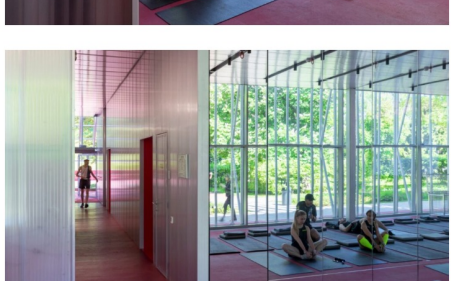
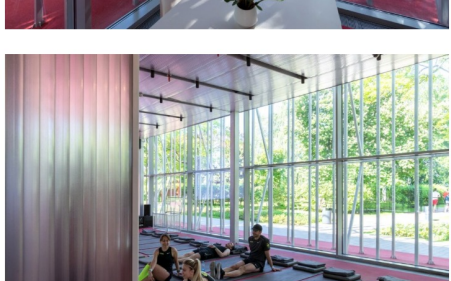
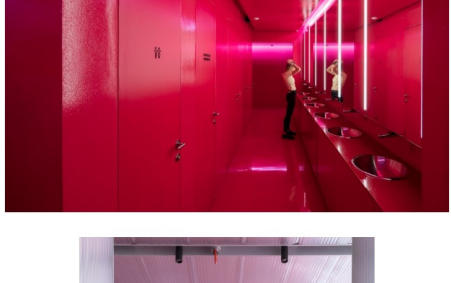
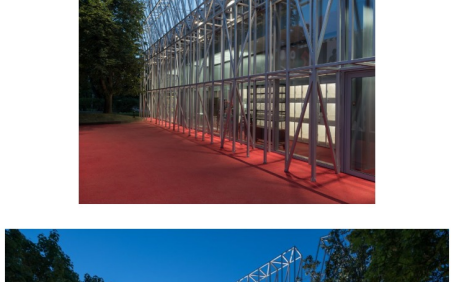
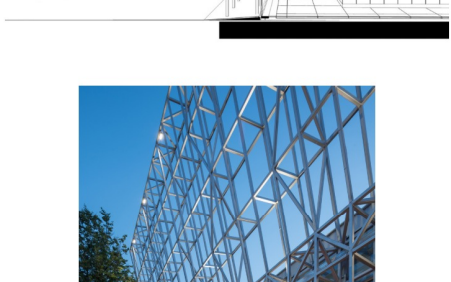
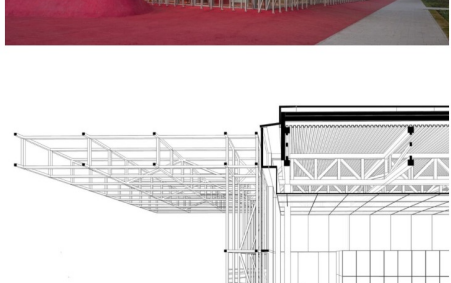
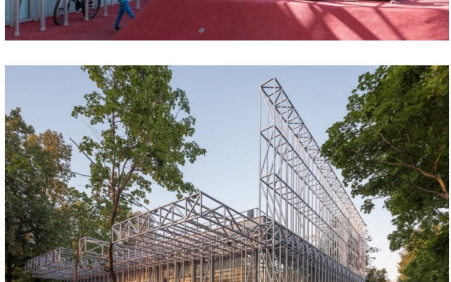
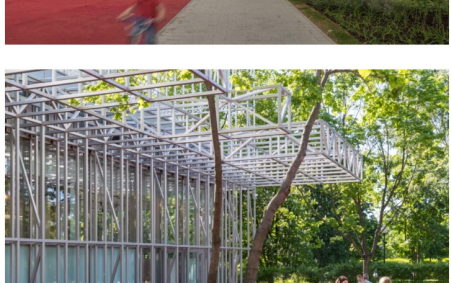
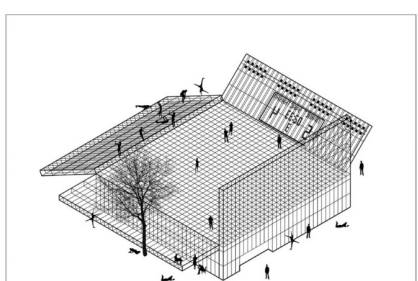
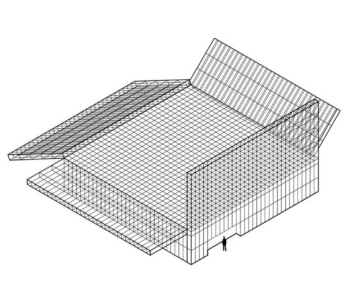
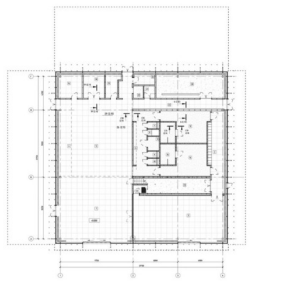
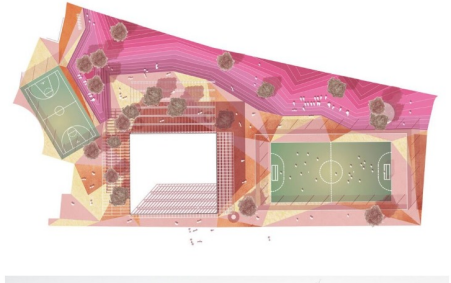
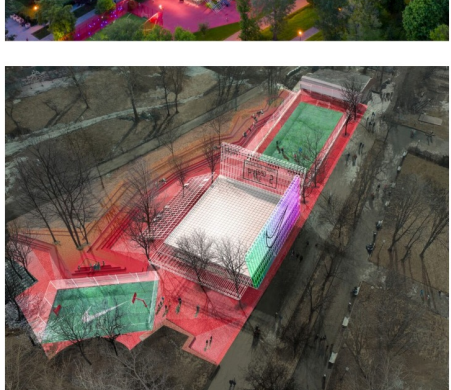
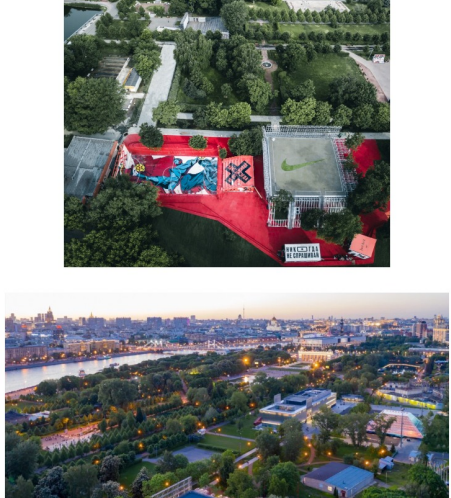
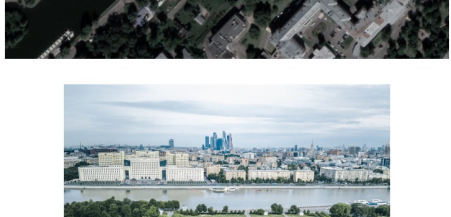

Other projects by Kosmos